

EAN: 4057304005664  
[static.hansa.com/58152171](http://static.hansa.com/58152171)



- Shower
- Thermostatic
- Wall mounted
- Chrome
- Temperature control handle, Flow control handle
- Eco flow control
- Safety stop against scalding at 38°C
- Ceramic head part for flow control, Non-return valve(s), Litter filter(s), Thermostatic cartridge for automatic temperature control
- Eccentric coupling(s), Reversed cold/hot water connection, Cover plate(s)
- swapped cold/hot water connections. protected against back-flow in domestic use (according to DIN EN 1717)

## Technical data

### Flow properties

Eco-flow at 3 bar	<b>11.4 l/min</b>
Flow-rate at 3 bar	<b>19.2 l/min</b>

### Technical properties

DN-size (nominal dimension)	<b>DN15</b>
Hot water supply	<b>max. +80°C</b>
Working pressure	<b>1-10 bar</b>
Connection size	<b>G 1/2</b>
Installation width	<b>cc150 ± 15 mm</b>

### Regulations

EN standard	<b>EN 1111</b>
-------------	----------------

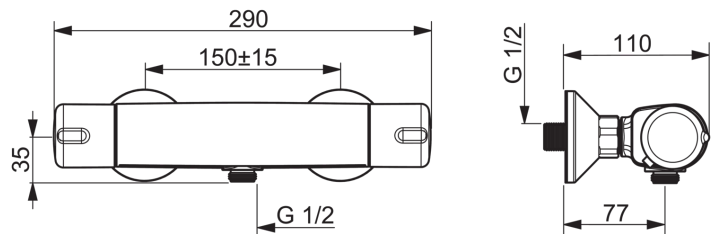
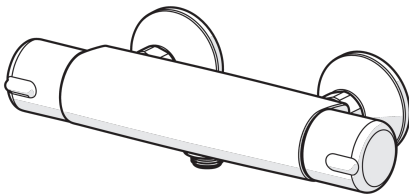
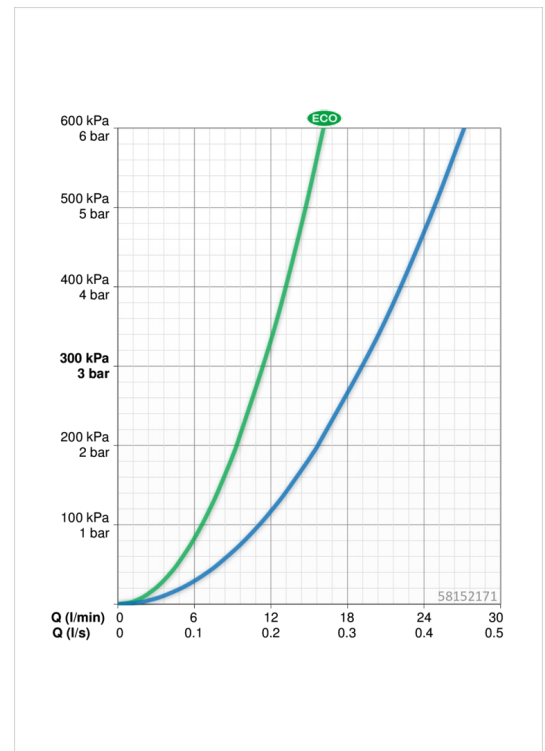

## Spare parts

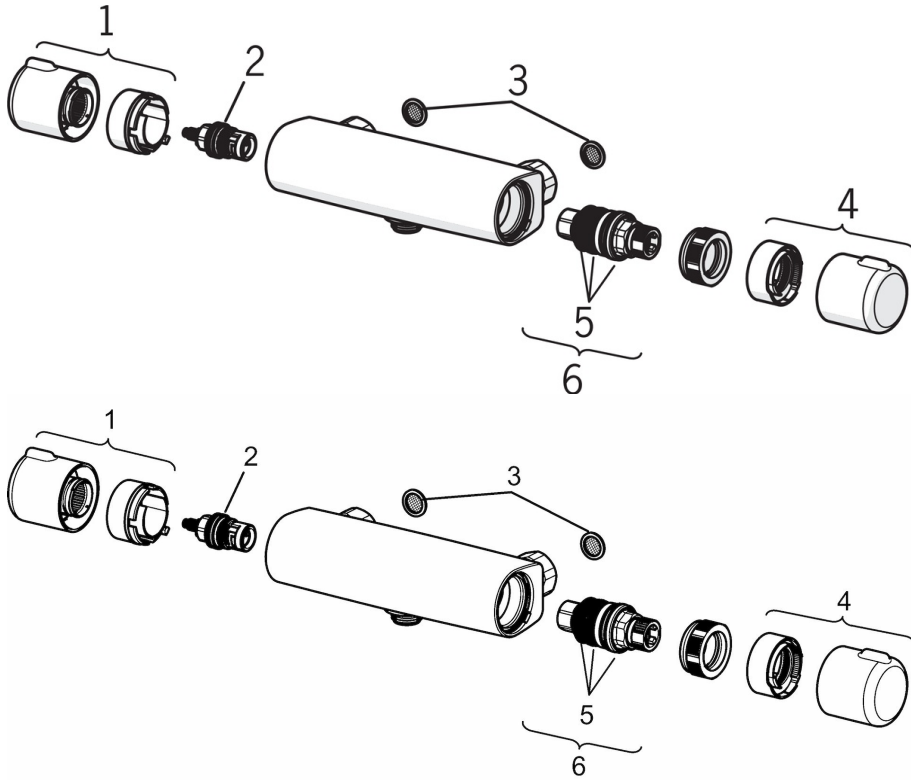

### SP58150171

	Name	Code
1	Flow control handle	59914395
2	Headpart, 1/2"	59914111
3	Filter sealing, G3/4	59911076
4	Temperature control handle	59914396
5	O-ring kit	59914113
6	Thermostatic cartridge, 3.4	59914114
N.I.	Tightening nut, M36x1.5, SW38	59914319
N.I.	Eccentric, G3/4 x G1/2	59904793
N.I.	Combiner	59914472