

EAN: 4057304003462
static.hansa.com/58150171



- Shower
- Thermostatic
- Wall mounted
- Chrome
- Temperature control handle, Flow control handle
- Eco flow control
- The housing of the fittings conducts minimal heat, Safety stop against scalding at 38°C
- Ceramic head part for flow control, Non-return valve(s), Litter filter(s), Thermostatic cartridge for automatic temperature control
- Eccentric coupling(s)
- protected against back-flow in domestic use (according to DIN EN 1717)

Technical data

Flow properties

| | |
|--------------------|-------------------|
| Eco-flow at 3 bar | 11.4 l/min |
| Flow-rate at 3 bar | 19.2 l/min |

Technical properties

| | |
|-----------------------------|----------------------|
| DN-size (nominal dimension) | DN15 |
| Hot water supply | max. +90°C |
| Working pressure | 1-10 bar |
| Installation width | cc150 ± 15 mm |

Regulations

| | |
|-------------|----------------|
| EN standard | EN 1111 |
|-------------|----------------|

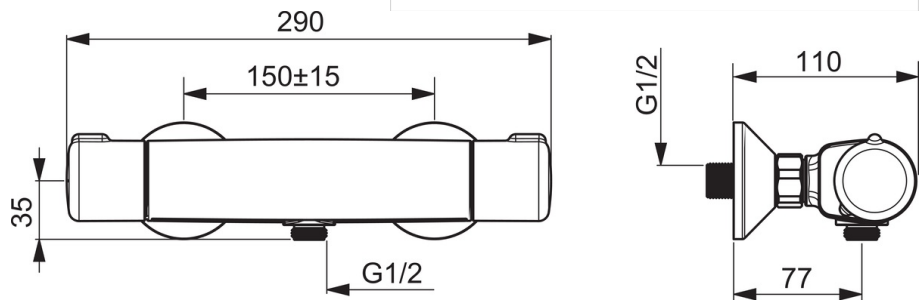
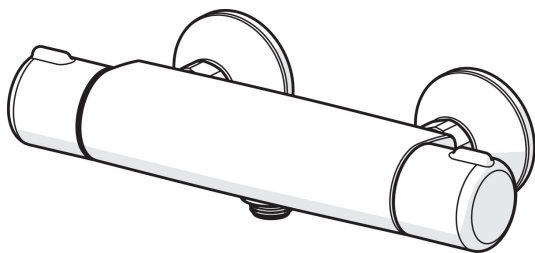
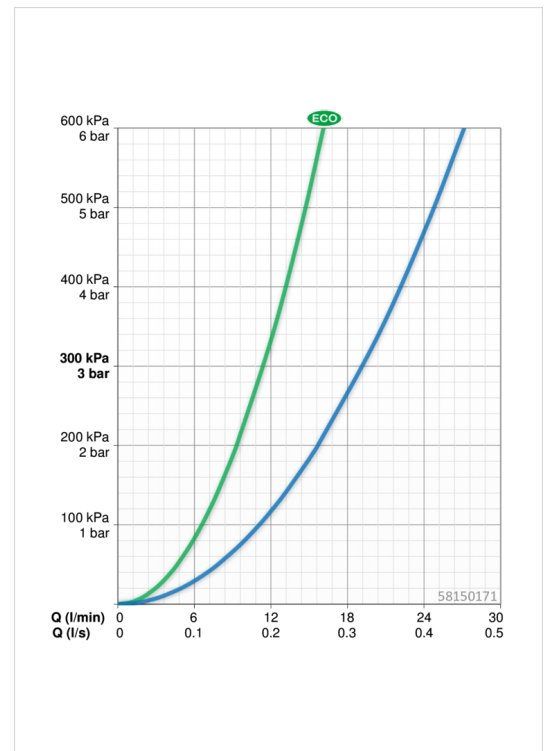

Spare parts

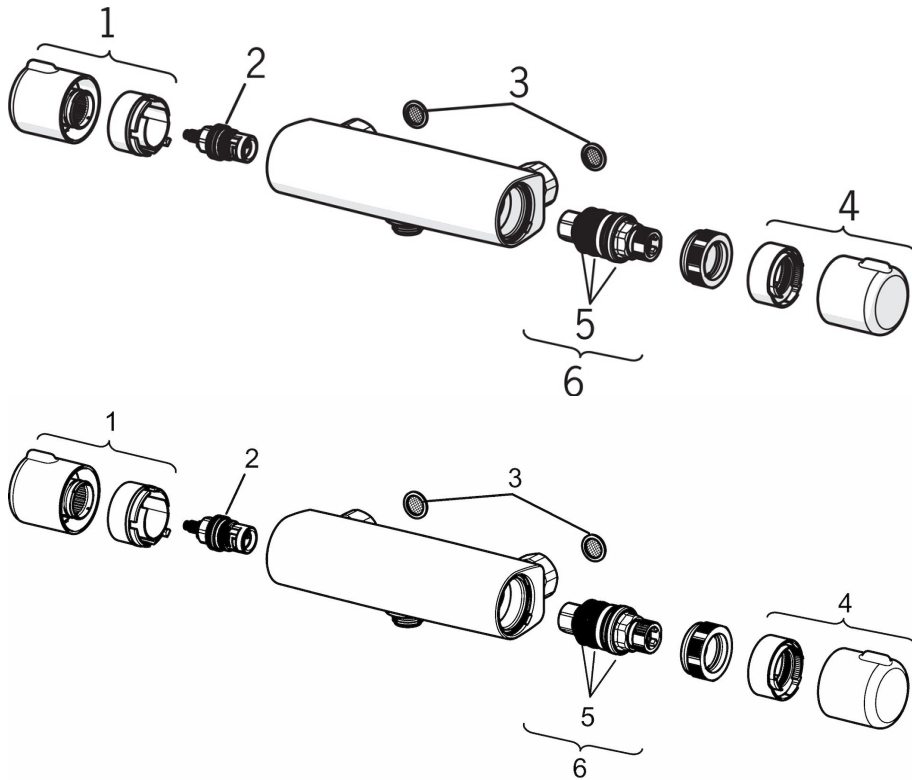

SP58150171

| | Name | Code |
|------|-------------------------------|----------|
| 1 | Flow control handle | 59914395 |
| 2 | Headpart, 1/2" | 59914111 |
| 3 | Filter sealing, G3/4 | 59911076 |
| 4 | Temperature control handle | 59914396 |
| 5 | O-ring kit | 59914113 |
| 6 | Thermostatic cartridge, 3.4 | 59914114 |
| N.I. | Tightening nut, M36x1.5, SW38 | 59914319 |
| N.I. | Eccentric, G3/4 x G1/2 | 59904793 |
| N.I. | Combiner | 59914472 |