

HANSA
HEADPART, G1/2
 02200100
EAN: 4015474598287



- Bathroom
- Non-ceramic head part for flow control
- body made of DZR brass

Technical data

Flow properties

Flow-rate at 3 bar

30.0 l/min

Technical properties

DN-size (nominal dimension)
 Hot water supply
 Working pressure
 Connection size

DN15
max. +90°C
1-10 bar
G1/2

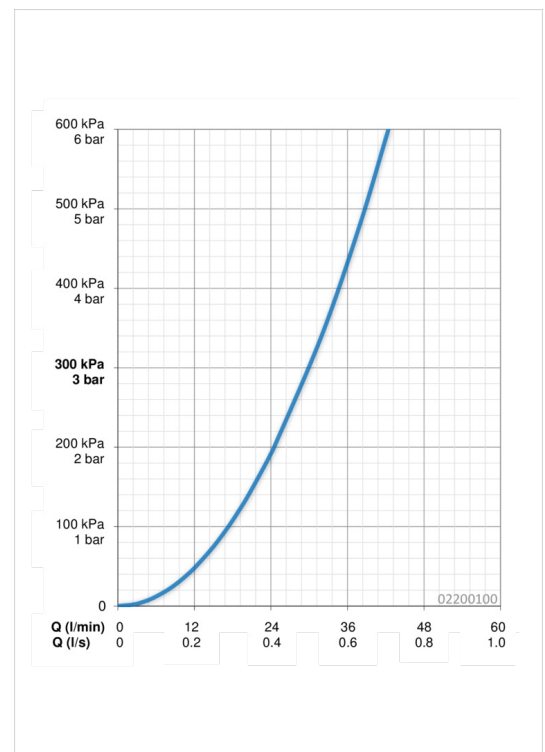

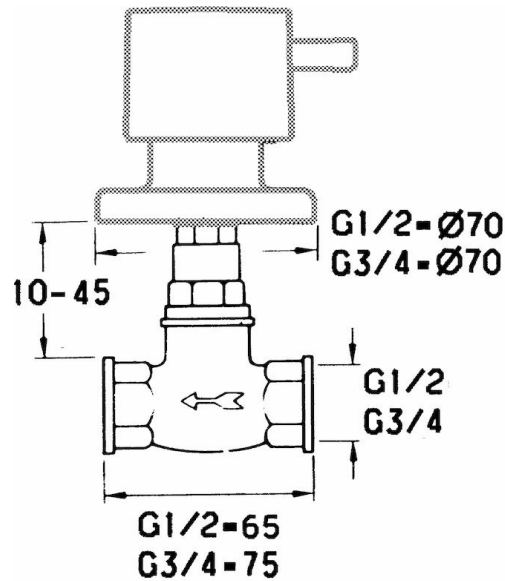
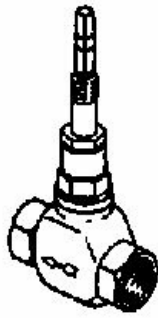

Spare parts

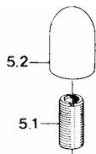

Unterputzventil DN 15 (G 1/2)

mit Gewindeanschluß DN 15

Einbautiefen:

X	von 10 bis 45 mm
	45 bis 80 mm
	80 bis 115 mm

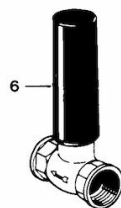
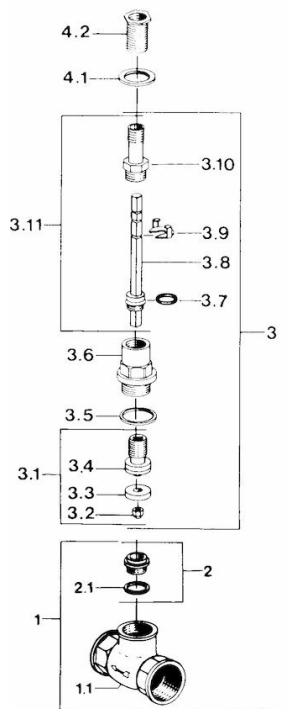

SP02200100

	Name	Code
1	Body	59902011
2	Seat, DN15, R1/2	59904616
2.1	Gasket, 18,5 x 15 x 1,5	59902314
3	Headpart, 10-45 mm, G1/2	59902723
3	Headpart, 80 - 115 mm, 1/2"	59901451
3	Headpart, 45-80 mm, G1/2	59902726
3.1	Valve	59904956
3.10	Thread nipple	59902620
3.11	Raising kit, L=150	59902701
3.11	Raising kit, 45-80 mm	59905576
3.11	Raising kit, 80-115 mm	59905577
3.3	Gasket ring	59902301
3.5	Gasket, 25 x 21 x 2	59902319
3.7	O-ring, d 9,25 x d 1,78	59902338
3.8	Spindle, 10 - 45 mm	59902695
3.8	Spindle, 45 - 80 mm	59902697
3.9	Spring clip	59901017
4.1	Knurled nut	59902621
4.2	Thread nipple, M12x1/M15x1, AF17	59902708
5.1	Thread nipple	59901373
5.2	Shut-off cap	59901106